

# Franklyn James



## Campania Building, Jardine Road

Limehouse, London, E1W 3WD

Offers In Excess Of £450,000

Franklyn James is proud to present this stunning river fronted one double bedroom south facing apartment located in Atlantic Wharf. Internally the property is finished to a high standard, and comprises of a naturally lit reception area, separate full fitted bespoke kitchen, good sized double bedroom with fitted wardrobes, and modern four-piece family bathroom suite. Further benefits included your own private balcony with direct river views, secure underground parking and day porter. Campana Building is located in the famed Atlantic Wharf and is situated just a short walk from Limehouse DLR and C2C stations, both of which offer excellent links into central London and Canary Wharf. You will also find the historic Narrow Street on your doorstep, which features an abundance of eateries/bars, as well as being within walking distance of Limehouse DLR station and Canary Wharf tube station for easy access into the City. You will also find the River Thames situated on your doorstep offering great routes for morning walks or evening runs.

- One double bedroom
- One bathroom
- Private balcony
- Great transport links
- Daytime porter
- Secure underground parking

viewing

Please contact our Limehouse Sales Office on 02077911777 if you wish to arrange a viewing appointment for this property or require further information.



C

# Floor Plan

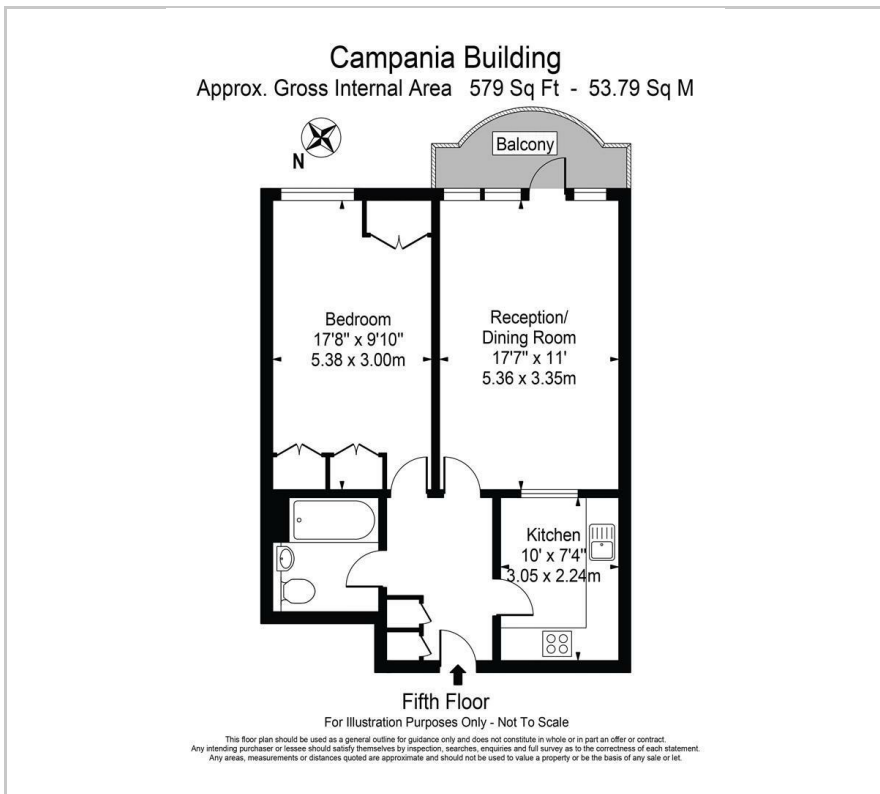

# Area Map



# Energy Efficiency Graph

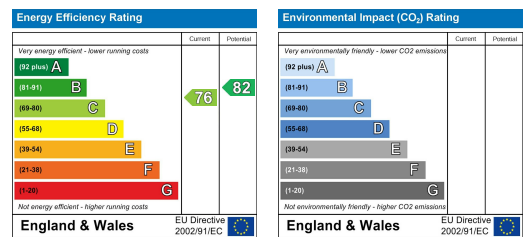

These particulars, whilst believed to be accurate are set out as a general outline only for guidance and do not constitute any part of an offer or contract. Intending purchasers should not rely on them as statements of representation of fact, but must satisfy themselves by inspection or otherwise as to their accuracy. No person in this firm's employment has the authority to make or give any representation or warranty in respect of the property.